

UNITY PARK

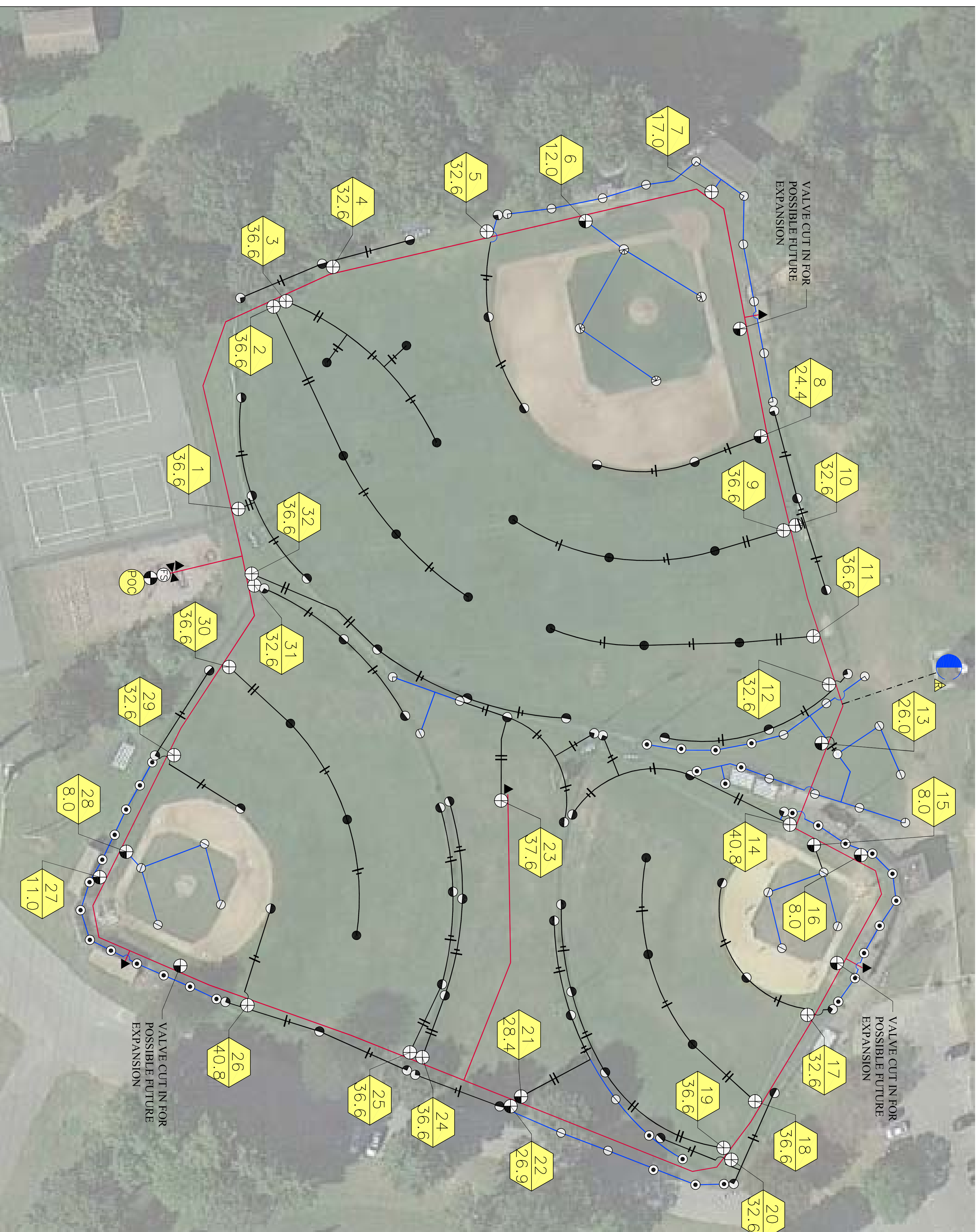

LEGEND

SYMBOL	DESCRIPTION
	RAIN BIRD ESP-LXME MODULAR CONTROLLER (35 STATIONS REQUIRED)
	HUNTER MINICLOCK RAIN SHUT-OFF DEVICE
	HUNTER I-25-04 ROTOR W/1/3 NOZZLE
	HUNTER I-25-04 ROTOR W/1/3 NOZZLE
	HUNTER I-25-04 ROTOR W/0/8 NOZZLE
	HUNTER PGP-ULTRA ROTOR W/3/0 NOZZLE
	HUNTER PGP-ULTRA ROTOR W/3/0SR NOZZLE
	HUNTER PGP-ULTRA ROTOR W/1/5SR NOZZLE
	HUNTER PGP-ULTRA ROTOR W/7/5SR NOZZLE
	HUNTER PGP-04-PR540 SPRAY W/MF2000 ROTATOR NOZZLE
	HUNTER PGP-150 ELECTRIC VALVE - 1 1/2"
	HUNTER PGP-100 ELECTRIC VALVE - 1"
	HUNTER PGP-150 MASTER VALVE - 1 1/2"
	DANA INDUSTRIAL FLOW SENSOR - 2"
	RAIN BIRD SRC-QCV QUICK COUPLING VALVE - 1"
	NIBCO I-29K-2 BRONZE GATE VALVE - 2"
	SLEEVES - PER LOCAL CODE
	MANLINE PIPE - CL. 200 PVC PIPE BE/SW - 2"
	LATERAL PIPE - CL. 200 PVC PIPE BE/SW - 2"
	LATERAL PIPE - S40 PVC PIPE BE/SW - 1 1/2"
	POINT OF CONNECTION AND BACKFLOW PREVENTION AS PER LOCAL CODE

LATERAL IDENTIFICATION

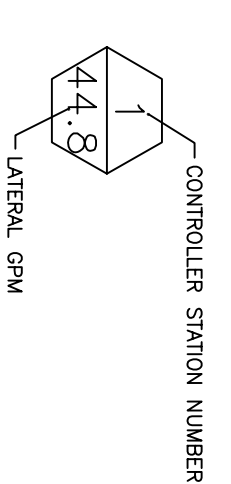

- SYSTEM NOTES:**
1. THE CONTROLLER SHALL BE A RAIN BIRD ESP-LXME MODULAR CONTROLLER.
 2. ALL MAINLINE PIPE SHALL BE CL. 200 PVC.
 3. ALL SPRINKLER PRODUCTS SHALL BE RAIN BIRD AND HUNTER.
 4. THE LOCATION OF ALL IRRIGATION IS DIAGNOSTIC AND SUBJECT TO FIELD VERIFICATION.
 5. 40.8 GPM @ 75 PSI IS REQUIRED AT THE POC TO OPERATE THE SYSTEM EFFICIENTLY.

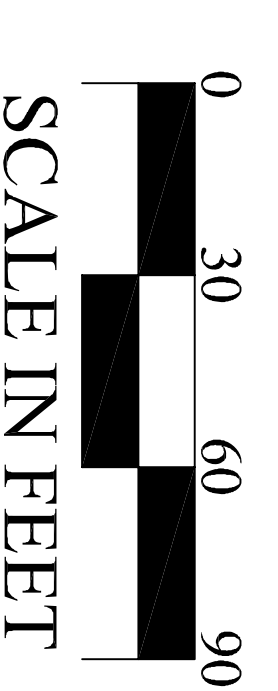

UNITY PARK

REVISIONS

NO.	DATE	DESCRIPTION

Irrigation Plan	
PROJECT NO.	DRAWN BY:
S-11276	SLH
SHEET	SCALE
1 OF 1	1" = 30'
DATE:	
27 JULY 2009	